



**PR**  
PROPERTY

154 Ridgway Road, Luton, LU2 7RT  
£1,600

- EXCLUSIVE TO PR PROPERTY LETTINGS
- DOWNSTAIRS WC
- CLOSE TO TRAIN STATION
- 3 BEDROOMS
- PRIVATE REAR GARDEN
- AVAILABLE NOW
- 2 RECEPTION ROOMS
- CLOSE TO TOWN CENTER
- MUST BE VIEWED

**\*\* Exclusive to PR Property \*\*** A well-located 3 bedroom house to rent on Ridgway Road, Luton, offering flexible living space with two reception rooms and a private rear garden. Set within easy reach of the town centre and Luton station, it's a handy option for commuters and anyone wanting everyday amenities close by. The layout suits a range of lifestyles, whether you need a separate dining space, a home office area, or just a bit of extra room to spread out. Available now and offered with viewings highly recommended to appreciate the space and setting.

## ENTRANCE HALL

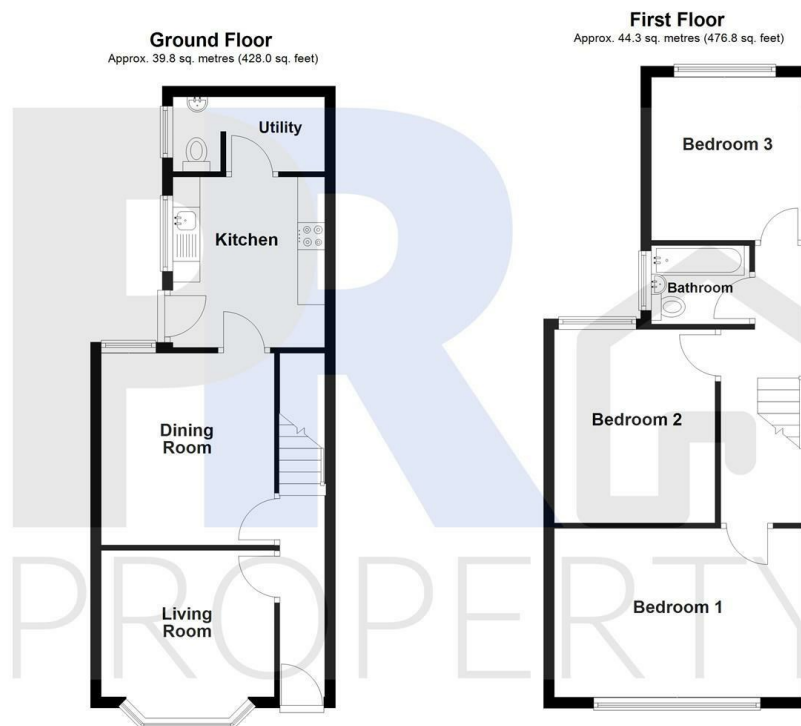

Total area: approx. 84.1 sq. metres (904.8 sq. feet)  
**154 Ridgway Road, Luton**

Energy Efficiency Rating		
	Current	Potential
Very energy efficient - lower running costs		
(92 plus) <b>A</b>		
(81-91) <b>B</b>		
(69-80) <b>C</b>		
(55-68) <b>D</b>		
(39-54) <b>E</b>		
(21-38) <b>F</b>		
(1-20) <b>G</b>		
Not energy efficient - higher running costs		
England & Wales		EU Directive 2002/91/EC